

36" STANDARD SHAPE FRAME

American
Panel HEARTH
PRODUCTS

HEARTH CLASSICS

BY American Panel

Hearth Pad Frame Assembly Instructions

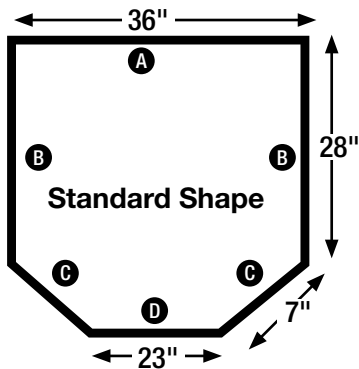

HINT:

Use liquid soap
on the plug
ends for easy
attaching.

PARTS INCLUDED:

- (3) 90° angle corner plugs
- (4) 22.5° angle corner plugs (corner shape will use 2)
- (2) Frame pieces at approximately 36" long
- (2) Frame pieces at approximately 28" long
- (1) Frame piece at approximately 23" long
(used in standard shape only)
- (2) Frame pieces at approximately 7" long
(corner shape will use 1)

***NOTE:** You may want to remove thick carpet/padding.

STEPS 1 - 2

With a 90° angle corner plug, attach the open end of the 36" frame piece (A) and one 28" frame piece (B).

STEPS 3 - 4

Using another 90° angle corner plug, take the remaining 28" frame piece (B) and attach to the open end of the 36" frame piece (A).

STEPS 5 - 6

With a 22.5° angle corner plug, attach one 7" frame piece (C) to the open end of the 28" frame piece (B). Then repeat on the other side (C & B).

STEPS 7 - 8

Finish the frame by attaching the 23" frame piece (D) to the 22.5° angle corner plugs.

LAST STEP

Take care to make sure all corner plugs are inserted completely in the frame piece.

Standard Shape Frame - Steps 1 - 2

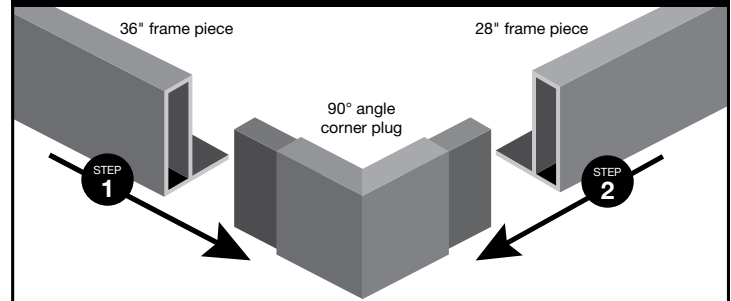

Standard Shape Frame - Steps 3 - 4

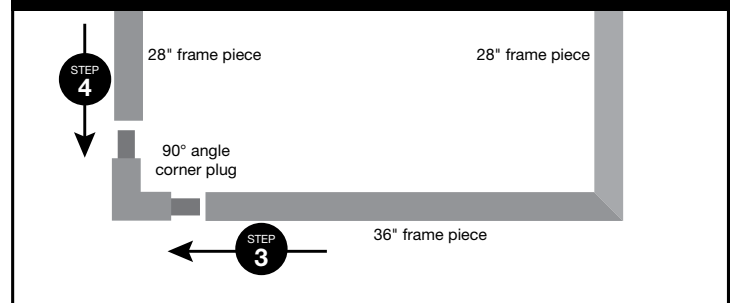

Standard Shape Frame - Steps 5 - 6

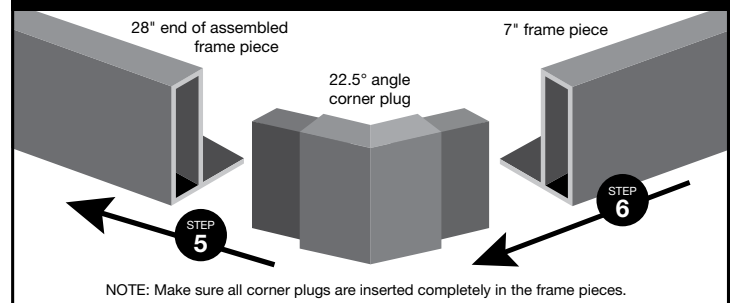

Standard Shape Frame - Steps 7 - 8

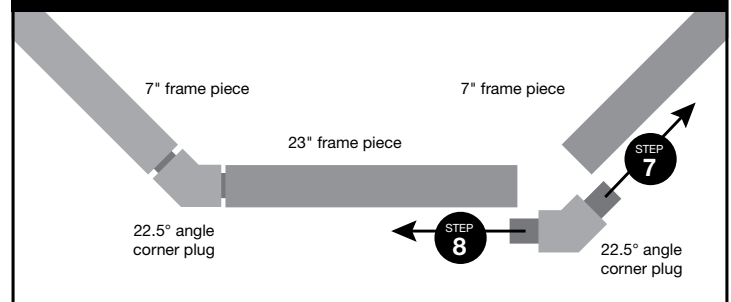

36" STANDARD SHAPE SUBSTRATE

American
Panel HEARTH
PRODUCTS

HEARTH CLASSICS
BY American Panel

Hearth Pad Substrate Assembly Instructions

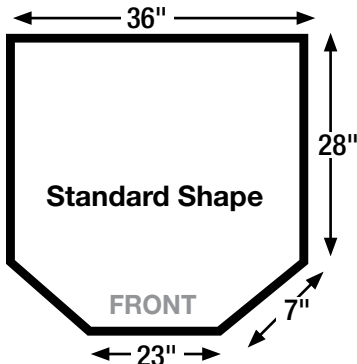

STANDARD SHAPE SUBSTRATE

MICORE 300 INCLUDED:

- (2) – 12" x 36" rectangle pieces
- (1) – 12" x 36" rectangle piece with two end cuts at 45°
- (1) – Tube of silicone
- (1) – Triangle piece (used in corner shape only)

CEMENT BOARD INCLUDED:

- (1) – 6" x 36" rectangle piece with two end cuts at 45°
- (1) – 6" x 36" rectangle piece
- (1) – 12" x 36" rectangle pieces
- (1) – 12" x 36" rectangle piece with two end cuts at 45°
- (1) – Triangle piece (used in corner shape only)

#1 MICORE 300 SUBSTRATE

(this is the ½" thick and slightly softer of the two substrates)

STEP 1

While positioned in front of the hearth pad (double lop will be in front of your knees), lay in (1) 12" x 36" rectangle piece with two end cuts starting from front to back and running left to right.

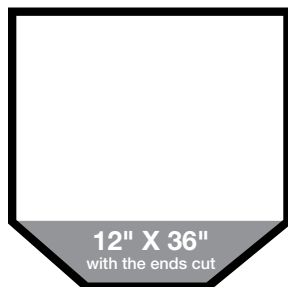

STEP 2

Lay in the (2) 12" x 36" rectangle pieces.

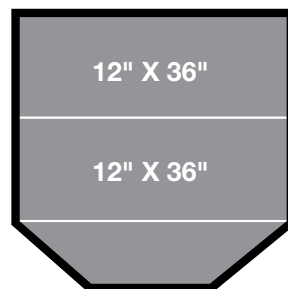

LAST STEPS

Run a bead of silicone around the outside edge and inside of the frame. Make several elongated "S" movements across all of the Micore 300.

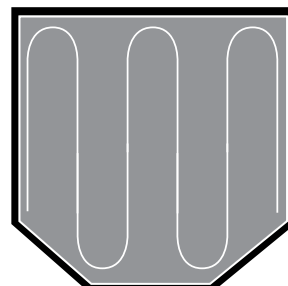

#2 CEMENT BOARD SUBSTRATE

Cement Board (this is ¼" thick and the harder of the two substrates)

STEP 1

Lay in (1) 6" x 36" rectangle piece with two end cuts starting from right to left and running from front to back.

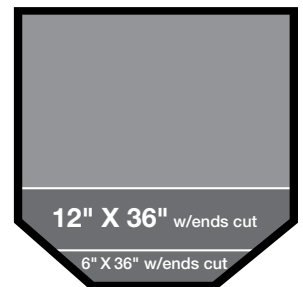

STEP 2

Lay in the (1) 12" x 36" rectangle pieces.

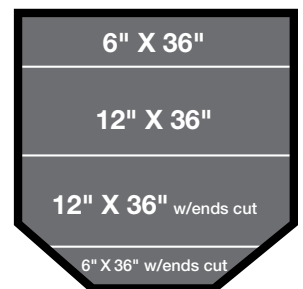

STEP 3

Lay in (1) 12" x 36" rectangle piece with two end cuts.

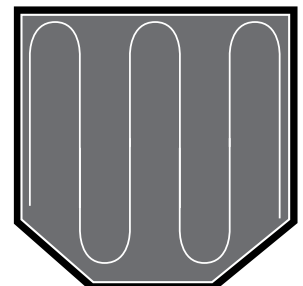

STEP 4

Lay in the (1) 6" x 36" rectangle piece.

LAST STEPS

Run a bead of silicone around the outside edge and inside of the frame. Make several elongated "S" movements across all of the cement board.

36" STANDARD SHAPE MODULAR PANELS

American
Panel HEARTH
PRODUCTS

HEARTH CLASSICS

BY American Panel

Hearth Pad Modular Panels Assembly Instructions

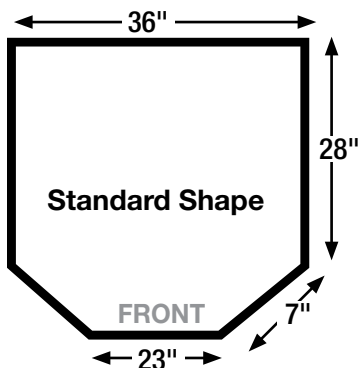

PARTS INCLUDED:

- (2) 12" x 36" modular panels
- (1) 12" x 24" modular panel with one end cut at 45°
- (1) 12" x 12" modular panel (used in corner shape only)
- (1) Triangle shape modular panel (used in standard shape only)
- (4) Load spreading disc (for appliances using legs or leveling bolts)

(2) 12" X 36" modular panels



triangle



12" X 24" with the end cut

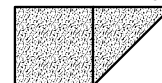

STANDARD MODULAR PANELS

STEP 1

While positioned in front of the hearth pad frame (double lip will be in front of your knees), lay in (2) 12" x 36" modular panel starting from back to front and running left to right.

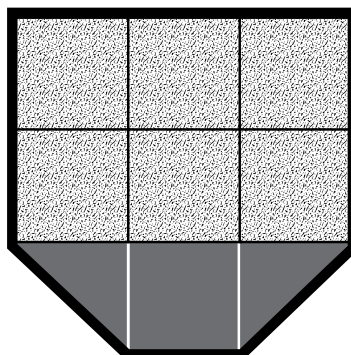

STEP 2

Lay in (1) 12" x 24" modular panel with one end cut - only one way this will go into frame.

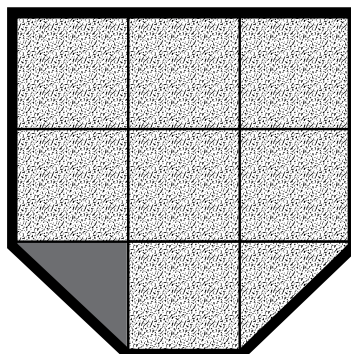

STEP 3

Lay in the triangle shape modular panel in the open area located at the bottom left corner.

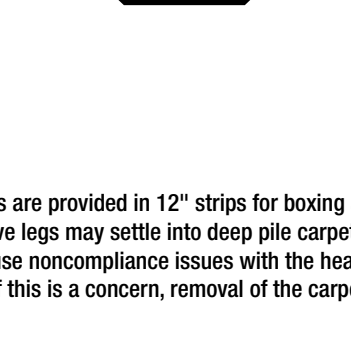

STEP 4

Square up the hearth pad taking care to make sure the tile lines are straight and modular panels are pushed to center. This may create a small gap between the frame and the outside edge of the tile.

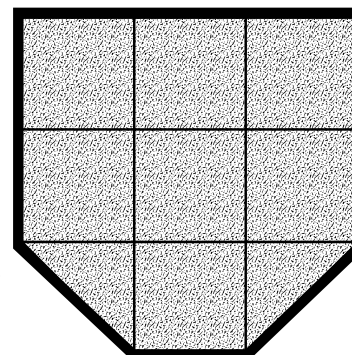

LAST STEP

For any appliance using legs or leveling bolts, place a load spreading disc beneath each leg to prevent pressure cracks.

***NOTE:** Modular and substrate panels are provided in 12" strips for boxing and shipping purposes. Once assembled, modular panels bearing the weight of the stove legs may settle into deep pile carpet. This is common with heavy stoves placed on thick carpet pile/padding. This will not cause noncompliance issues with the hearth pad; however, it may create a slightly noticeable unevenness in the modular panels. If this is a concern, removal of the carpet/padding and setting of the hearth pad on a hard, flat surface will eliminate the issue.