

60" CORNER SHAPE FRAME

American
Panel HEARTH
PRODUCTS

HEARTH CLASSICS
BY American Panel

Hearth Pad Frame Assembly Instructions

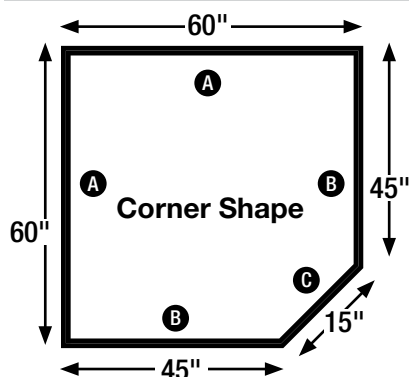

HINT:
Use liquid soap
on the plug
ends for easy
attaching.

PARTS INCLUDED:

- (3) 90° angle corner plugs
- (2) 180° angle plugs (standard shape will use 1)
- (2) 11" long frame extension (standard shape will use 1)
- (4) 22.5° angle corner plugs (corner shape will use 2)
- (4) Frame pieces at approximately 45" long
- (1) Frame piece at approximately 39.5" long (used in standard shape only)
- (2) Frame pieces at approximately 15" long (corner shape will use 1)

***NOTE:** You may want to remove thick carpet/padding.

STEPS 1 - 4

To create one 60" frame piece (A), connect together (1) 45" frame piece, (1) 180° angle plug, and (1) 11" frame extension. Repeat to have two, 60" frame pieces.

STEPS 5 - 6

With a 90° angle corner plug, attach the two 60" frame pieces (A & A).

STEPS 7 - 10

Using a 90° angle corner plug, attach (1) 45" frame piece (B) to the open end of the 60" frame piece (A). Then repeat on the other side (B & A).

STEPS 11 - 12

With a 22.5° angle corner plug, attach (1) 15" frame piece (C) to the open end of the 45" frame piece (B).

STEPS 13 - 14

Using the remaining 22.5° angle corner plug, finish the frame by attaching the 15" frame piece (C) to the open end of the other 45" frame piece (B).

LAST STEP

Take care to make sure all corner plugs are inserted completely in the frame piece.

Corner Shape Frame - Steps 1 - 4

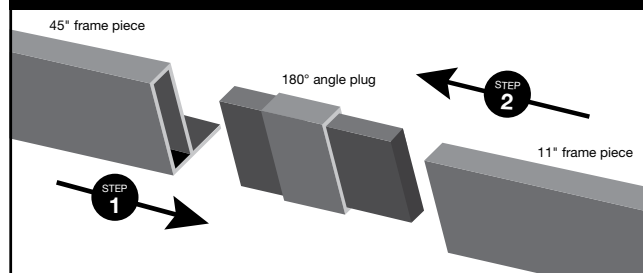

Corner Shape Frame - Steps 5 - 6

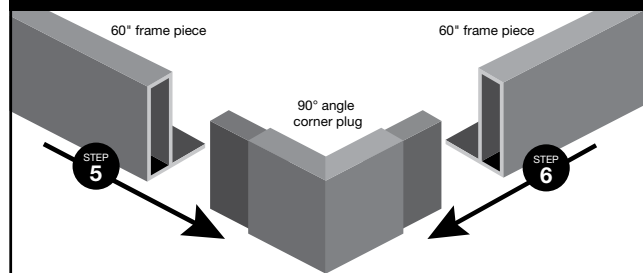

Corner Shape Frame - Steps 7 - 10

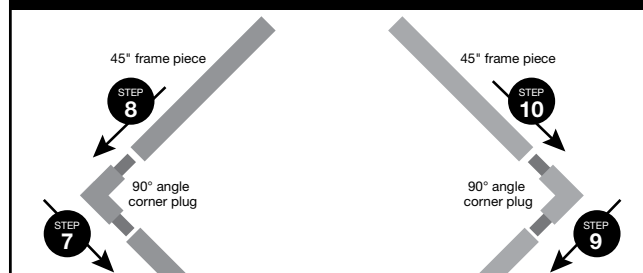

Corner Shape Frame - Steps 11 - 12

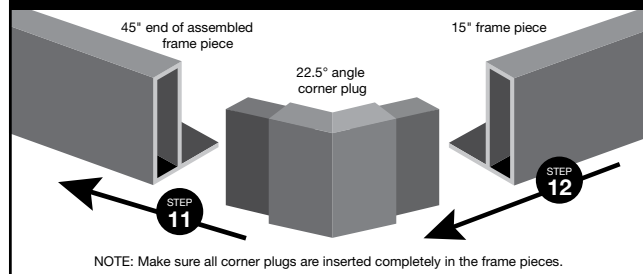

Corner Shape Frame - Steps 13 - 14

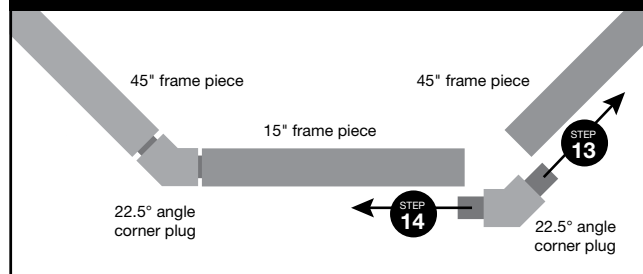

60" CORNER SHAPE SUBSTRATES

American
Panel HEARTH
PRODUCTS

HEARTH CLASSICS

BY American Panel

Hearth Pad Substrate Assembly Instructions

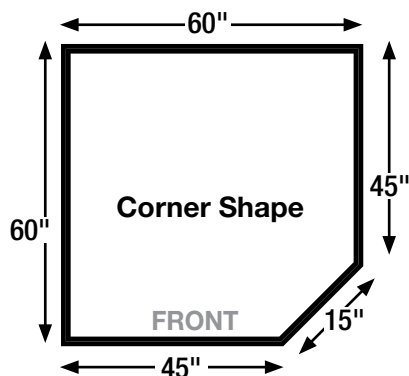

CORNER SHAPE SUBSTRATES

MICORE 300 INCLUDED:

- (4) – 12" x 23" rectangle pieces
- (4) – 12" x 36" rectangle pieces
- (1) – 12" x 23" rectangle piece with one end cut at 45°
- (1) – 12" x 36" rectangle piece with one end cut at 45°
- (1) – Tube of silicone
- (1) – Triangle piece (used in corner shape only)

CEMENT BOARD INCLUDED:

- (3) – 12" x 23" rectangle pieces
- (3) – 12" x 36" rectangle pieces
- (1) – 6" x 36" rectangle piece
- (1) – 6" x 23" rectangle piece
- (1) – 12" x 23" rectangle piece with one end cut at 45°
- (1) – 12" x 36" rectangle piece with one end cut at 45°
- (1) – 6" x 14" rectangle piece with one end cut at 45°
- (1) – 6" x 32" rectangle piece with one end cut at 45°
- (1) – Triangle piece (used in corner shape only)

#1 MICORE 300 SUBSTRATE

(this is ½" thick and slightly softer of the two substrates)

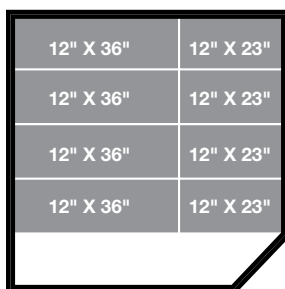

STEPS 1 - 2

While positioned in front of the hearth pad (single lop will be in front of your right knee), lay in side-by-side (4) 12" x 36" rectangle pieces and (4) 12" x 23" rectangle pieces starting from back to front and running left to right.

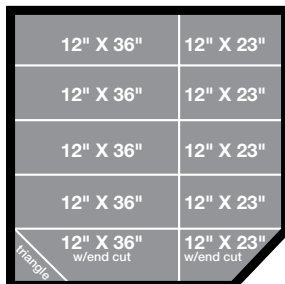

STEPS 3 - 5

From left to right, lay in the triangle piece, (1) 12" x 36" rectangle piece with one end cut, and (1) 12" x 23" rectangle piece with one end cut.

LAST STEPS

Run a bead of silicone around the outside edge and inside of the frame. Make several elongated "S" movements across all of the Micore 300.

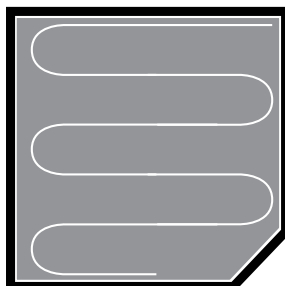

#2 CEMENT BOARD SUBSTRATE

(this is ¼" thick and the harder of the two substrates)

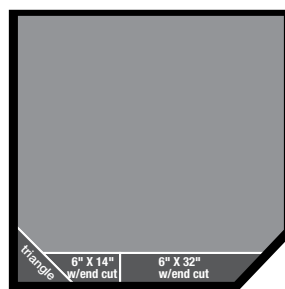

STEPS 1 - 3

Starting from left to right and running from front to back, place in the triangle piece, (1) 6" x 14" rectangle piece with one end cut, and (1) 6" x 32" rectangle piece with one end cut.

STEPS 4 - 5

Lay in side-by-side (1) 12" x 23" rectangle piece with one end cut and (1) 12" x 36" rectangle piece with one end cut.

STEP 6 - 7

Lay in side-by-side (3) 12" x 23" rectangle pieces and (3) 12" x 36" rectangle pieces.

STEPS 8 - 9

Lay in side-by-side (1) 6" x 23" rectangle piece and (1) 6" x 36" rectangle piece.

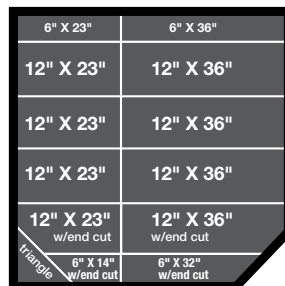
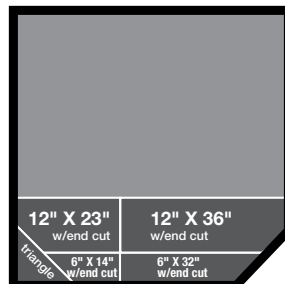

LAST STEPS

Run a bead of silicone around the outside edge and inside of the frame. Make several elongated "S" movements across all of the cement board.

60" CORNER SHAPE MODULAR PANELS

American
Panel HEARTH
PRODUCTS

HEARTH CLASSICS

BY American Panel

Hearth Pad Modular Panels Assembly Instructions

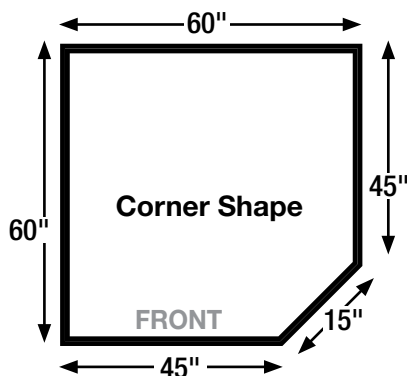

PARTS INCLUDED:

- (5) 12" x 48" modular panels
- (1) 12" x 48" modular panel with one end cut at 45°
- (1) 12" x 12" modular panel (used in corner shape only)
- (1) Triangle shape modular panel (used in standard shape only)
- (4) Load spreading disc (for appliances using legs or leveling bolts)

(5) 12" X 48" modular panels



12" X 48" with the end cut



triangle 12" X 12"

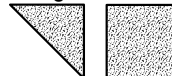

CORNER MODULAR PANELS

STEP 1

While positioned in front of the hearth pad frame (single lop will be in front of your right knee), lay in (4) 12" x 48" modular panels starting from back to front and running left to right.

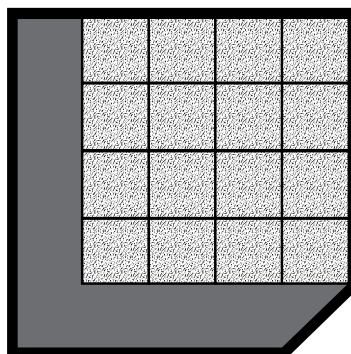

STEP 2

Lay in (1) 12" x 48" modular panel with one end cut - only one way this will go into frame.

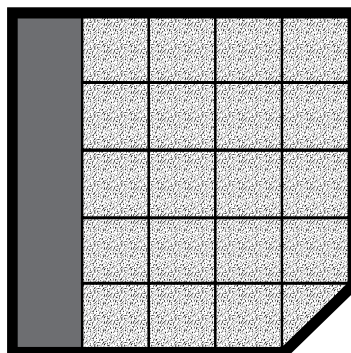

STEP 3

Lay in the 12" x 12" square modular panel in the open area located at the bottom left corner.

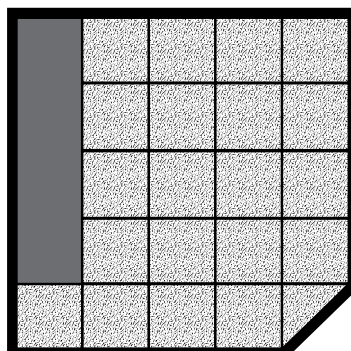

STEP 4

Lay in remaining 12" x 48" modular panel - only one way this will go into frame.

STEP 5

Square up the hearth pad taking care to make sure the tile lines are straight and modular panels are pushed to center. This may create a small gap between the frame and the outside edge of the tile.

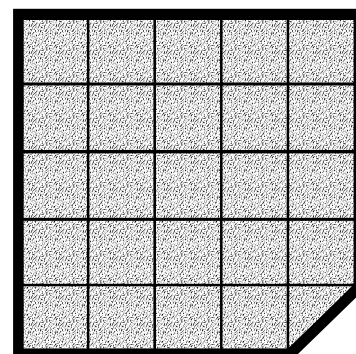

LAST STEP

For any appliance using legs or leveling bolts, place a load spreading disc beneath each leg to prevent pressure cracks.

***NOTE:** Modular and substrate panels are provided in 12" strips for boxing and shipping purposes. Once assembled, modular panels bearing the weight of the stove legs may settle into deep pile carpet. This is common with heavy stoves placed on thick carpet pile/padding. This will not cause noncompliance issues with the hearth pad; however, it may create a slightly noticeable unevenness in the modular panels. If this is a concern, removal of the carpet/padding and setting of the hearth pad on a hard, flat surface will eliminate the issue.